

The Gatesafe is an emergency exit device that overrides the locking mechanism of the AI and AIE, to provide an exit in case of an emergency. The Gatesafe emergency stop button both isolates the power supply and provides an emergency exit from the area. The switch contact arrangement of 2n/c 1n/o make it ideal for safety applications where cross monitoring may be required. These features also make it ideal for full body access areas where there may be the risk that the doors are locked closed while personnel are inside. The Gatesafe is designed to operate as part of an access control system.

Operation

① Door is locked

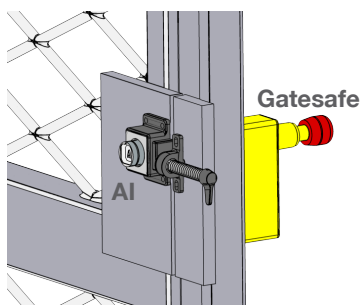

Bolt is in a locked position.

② Intermediate Position

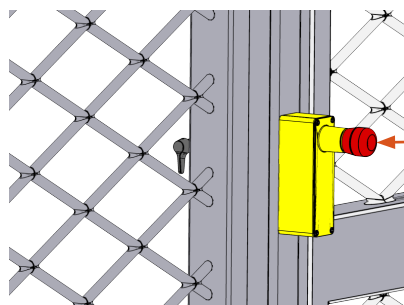

E-stop button is pressed.

③ Door is free

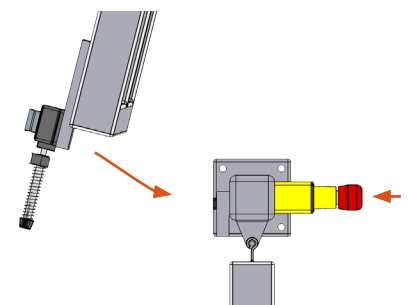

AI bolt is released, door can now be opened and switch contacts are changed and can be used to bring machine to a safe condition.

Application

In a typical application, under normal operating conditions the key is trapped in the KS key switch interlock and the access lock is locked to prevent access to the guarded area. The key is removed from the KS and inserted and turned in the access lock. The lock bolt is then withdrawn to gain entry to the area. While the operator is inside it is possible that somebody could close the door and re-energize the machinery. To evacuate the area the operator would depress the Gatesafe E-stop button to shut down the machinery and also override the access lock to achieve immediate escape from the area. The E-stop button and coded bolt both need to be reset to allow machine start up. The n/o E-stop contact can be connected to an alarm system for signaling.

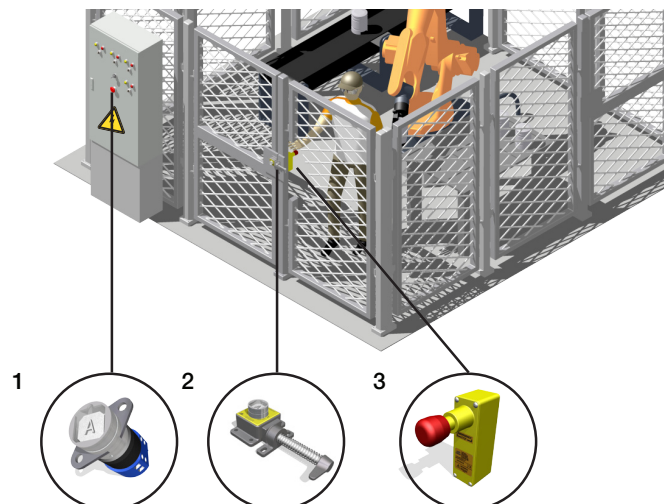

Technical Data

Working Temperature	Minimum: -40°C [-40°F] Q & FS Type
	Maximum: 107°C [224.6°F] Q Type / 140°C [284°F] FS Type
Type of mounting	1/4" or M6
Weight	Keypress: 2.0 kg Extension: 0.5 kg
Material	Stainless steel with aluminum body
Standards & Approvals	IEC 947-5-1, VDE 0660.0113; VDE, UL & CSA
Switch Ratings	IP65, 400 V AC max, 6A AC max, 2 n/o 1n/c contacts

Dimensions:
mm [inches]

Note: For safe mounting, use security screws

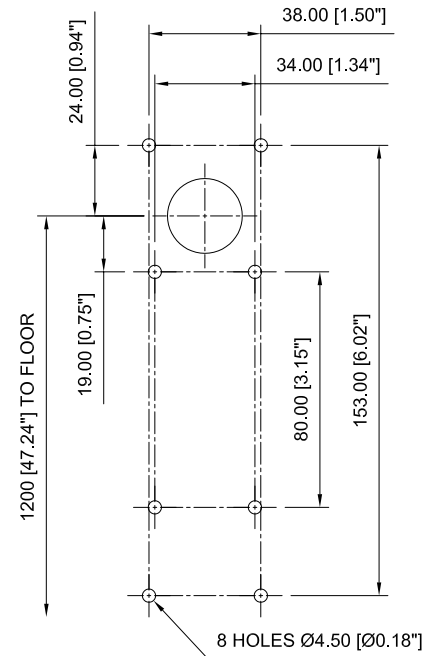
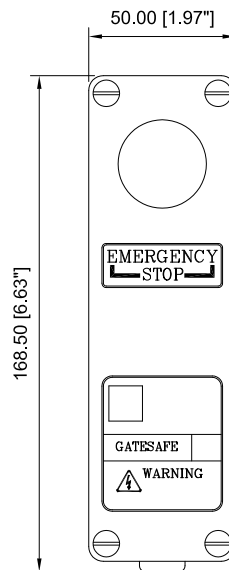
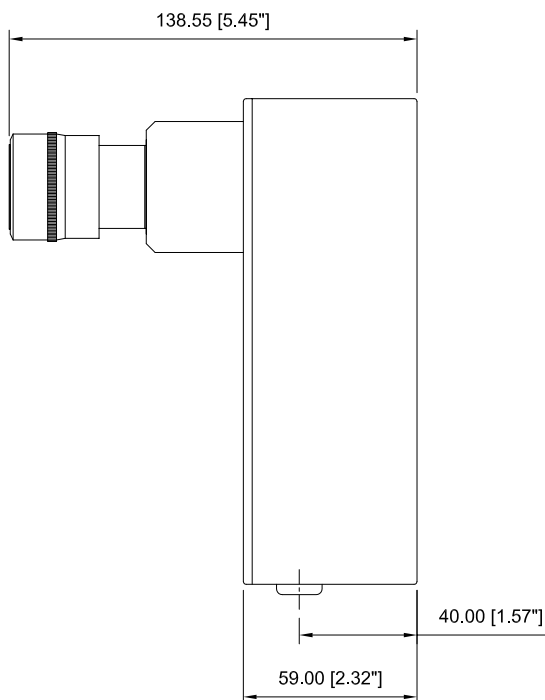

Order Information

Part Number *1*

 -

Example

 -

1 *Optional* Accessories

KEY



With Keyswitch (used if key is required to reset Gatesafe once operated)

EXT

Doorjam Extension Kit (extends connection from Gatesafe to access interlock for door frames 20mm - 100 mm)

Individual preparations upon inquiry

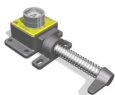
Accessories

	Product	P/N
	AI	AI Access Interlock
	AIE	Dual Key Access Interlock

Contact Information

Castell Interlocks, Inc.
21 Kenton Lands Road
Erlanger, KY 41018

phone: +1.859.341.3075
fax: +1.859.957.1577
toll free: +1.877.341.3075
www.castell.com

580.0040.00 - 12/18/08